

0130820

**2008- 2009 JEEP JK 4 DOOR, MUFFLER
SKID PLATE**

**OFF CAMBER
FABRICATIONS**

by: **MBRP** INC.

NOTE: FOR USE WITH MBRP S5514409 OR S5514AL EXHAUST SYSTEM

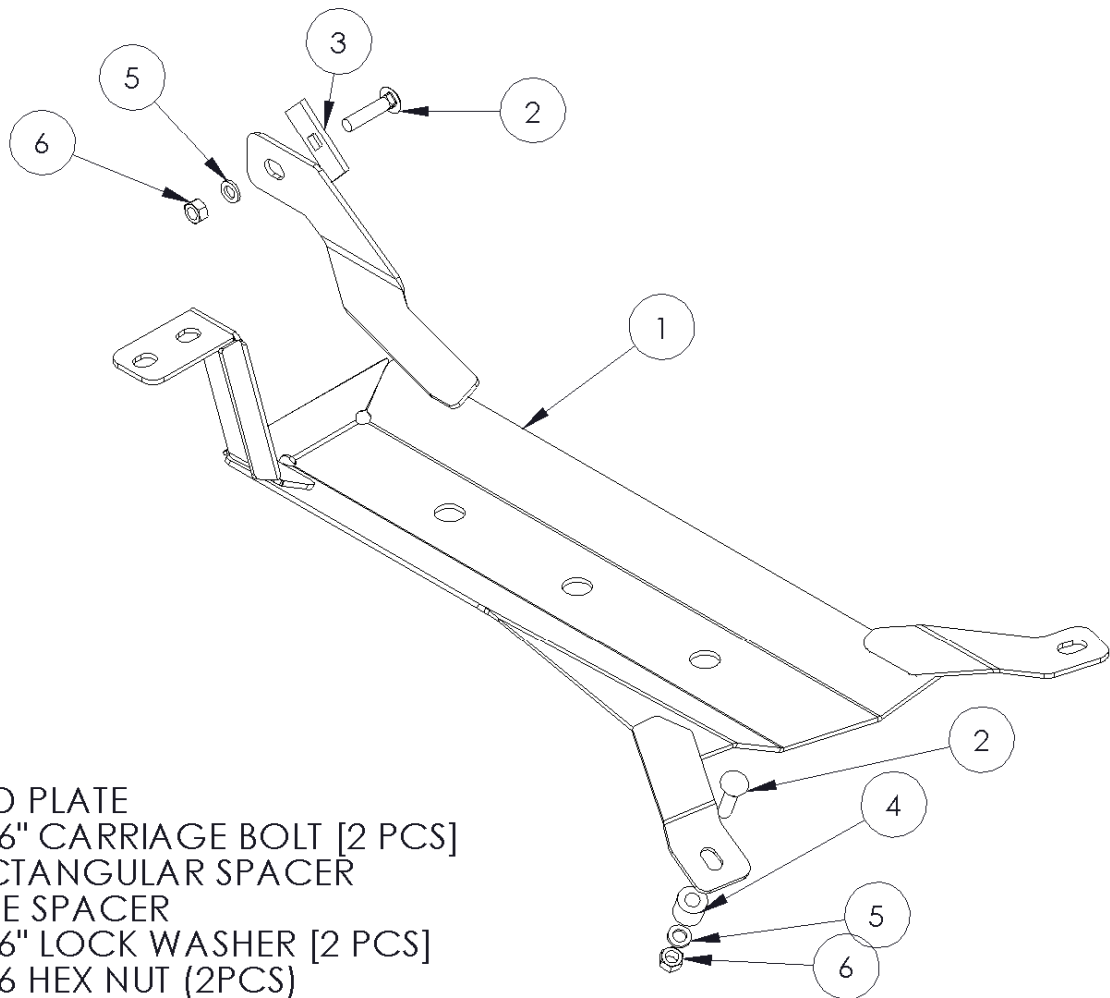

1. SKID PLATE
2. 7/16" CARRIAGE BOLT [2 PCS]
3. RECTANGULAR SPACER
4. TUBE SPACER
5. 7/16" LOCK WASHER [2 PCS]
6. 7/16 HEX NUT (2PCS)

PLEASE READ BEFORE STARTING INSTALLATION

While MBRP Inc. has made every effort to ensure that all components of this kit are of superior quality and properly packaged, it is the installer's responsibility to ensure the following before starting:

- that ALL components shown above are present.
- that ALL mating components fit together.
- that there are no damaged components.
- that the kit you have purchased is appropriate for your year and model of vehicle.
- that the kit will not interfere with any modifications previously installed or planned.
- that you have read and understand these instructions.

If you have any questions or are uncertain about any aspect of the installation of this kit on your vehicle please contact your dealer before commencing installation.

2008-2009 Jeep JK 4DR Muffler Skid Plate



Figure 1

1. Remove the fastener on the existing cross-member. Remove the two foremost fasteners on the front of the charcoal canister. Retain the hardware for installation. **Refer to Figure 1.**

2. Loosely install the **Skid Plate** between the frame and the existing skid plate and charcoal canister. Reuse the hardware removed in step 1. **Refer to Figure 2.**



Figure 2

3. A **7/16" Carriage Bolt** and the **Rectangular Spacer** are inserted into the frame and fished through the existing hole in the frame and rear driver's side bracket of the skid plate. A piece of mechanic's wire can be wrapped around the **7/16" Carriage Bolt** and through the **Rectangular Spacer**. Secure with a **7/16" Lock Washer** and a **7/16" Hex Nut**. **Refer to Figure 3.**

4. A **1/2"** drill will be required for the passenger side front bracket. Mark the hole with a center punch using the bracket as a guide. After drilling, insert the **Tube Spacer** between the bracket and the existing cross-member. Insert a **7/16" Carriage Bolt** through the bracket, **Tube Spacer** and existing cross-member. Add a **7/16" Lock Washer** and **7/16" Hex Nut** below the cross-member. **Refer to Figure 4.**

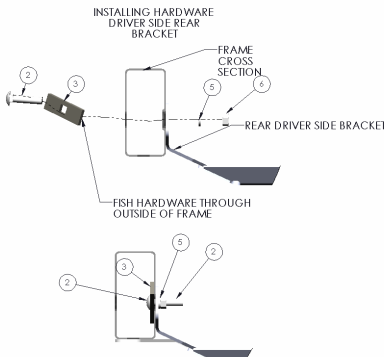

Figure 3

5. Check for clearance around the muffler, adjust if necessary and tighten all hardware.



Figure 4



Now You Are Done! We are certain that this MBRPinc product will contribute to many years of enjoyment.