

S5522

00-06 JEEP WRANGLER/RUBICON (TJ), 04-06 UNLIMITED (EXTENDED), 4.0L I-6, CAT BACK, TURN DOWN

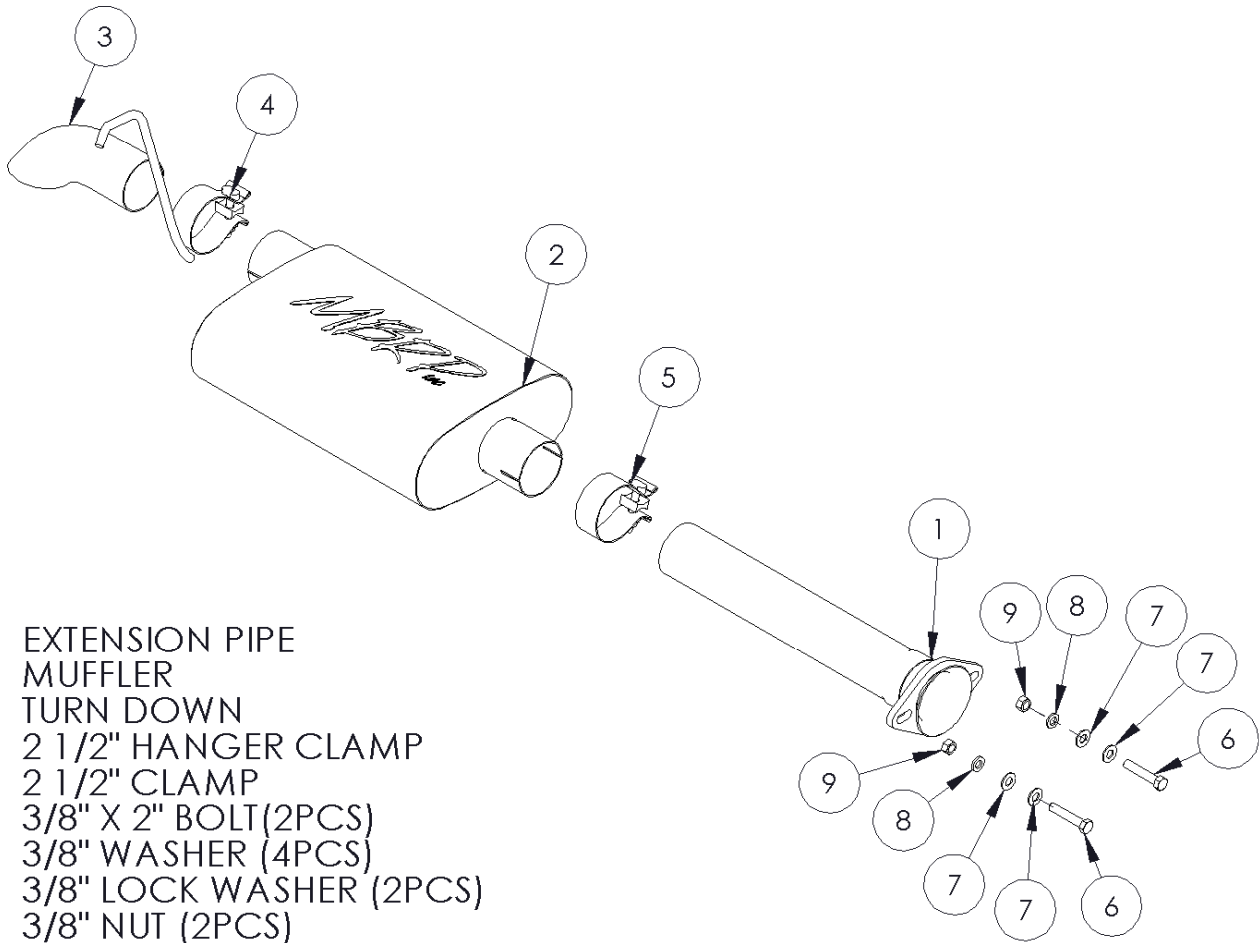

1. EXTENSION PIPE
2. MUFFLER
3. TURN DOWN
4. 2 1/2" HANGER CLAMP
5. 2 1/2" CLAMP
6. 3/8" X 2" BOLT (2PCS)
7. 3/8" WASHER (4PCS)
8. 3/8" LOCK WASHER (2PCS)
9. 3/8" NUT (2PCS)

PLEASE READ BEFORE STARTING INSTALLATION

While MBRP Inc. has made every effort to ensure that all components of this system are of superior quality and properly packaged, it is the installer's responsibility to ensure the following before removal of the factory exhaust:

- that ALL components shown above are present.
- that ALL mating components fit together.
- that there are no damaged components.
- that the system you have purchased is appropriate for your vehicle year, model and configuration.
- that the system will not interfere with any modifications previously installed or planned.
- that you have read and understand these instructions.

If you have any questions or are uncertain about any aspect of the installation of this system to your vehicle please contact your dealer before commencing installation.

2000-2006 Jeep Wrangler (TJ)
2004-2006 Jeep Wrangler Unlimited

Removal of Stock System:

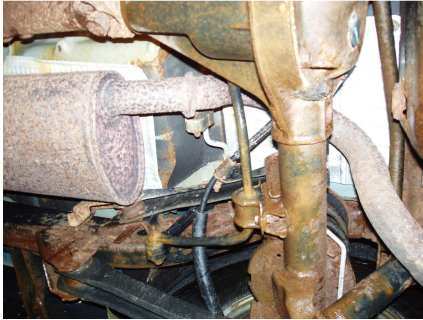

Figure 1

1. Apply a penetrating lubricant liberally to all exhaust fasteners, hangers and rubber insulators.



Figure 2

2. Cut the exhaust pipe after the muffler to be able to remove it from the vehicle. **Refer to Figure 1.**

3. Remove the tail section of the exhaust by removing it from the rubber isolators. **Refer to Figure 2.**



Figure 3

4. Remove the hardware from the flange and remove the muffler. **Refer to Figure 3.**

Installation of MBRP Inc. Performance Exhaust:



Figure 4

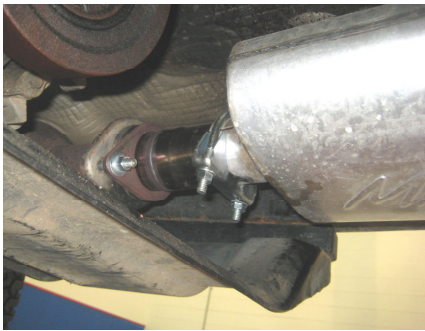

Figure 5



Figure 6



Figure 7

1. For the Unlimited Wrangler install the **Extension Pipe** to the existing flange using the fasteners provided. **Refer to Figure 4.** For the regular length TJ the **Extension Pipe** will need to be shortened 10”.

2. Slide the 2 ½” **Clamp** over the **Muffler** inlet and then install it to the **Extension Pipe**. **Refer to Figure 5.**

3. Slide the 2 ½” **Hanger Clamp** over the **Muffler** outlet and then install the **Turn Down** to the **Muffler**. Install the hanger of the 2 ½” **Hanger Clamp** into the existing rubber insulator. **Refer to Figures 6 & 7.**

4. Align the exhaust as required. Starting at the front of the exhaust, tighten all clamps and connections. Check along the whole length of the exhaust system to ensure that there is adequate clearance around the spare tire, fuel and brake lines or any wiring. If any interference is detected relocate or adjust.



Congratulations! You are ready to begin experiencing the improved power, sound and driving experience of your MBRP Inc. performance exhaust system. We know you will enjoy your purchase.