

S5520

04-06 JEEP WRANGLER/RUBICON (TJ)
UNLIMITED (EXTENDED), 4.0L I-6, CAT BACK,
SINGLE SIDE

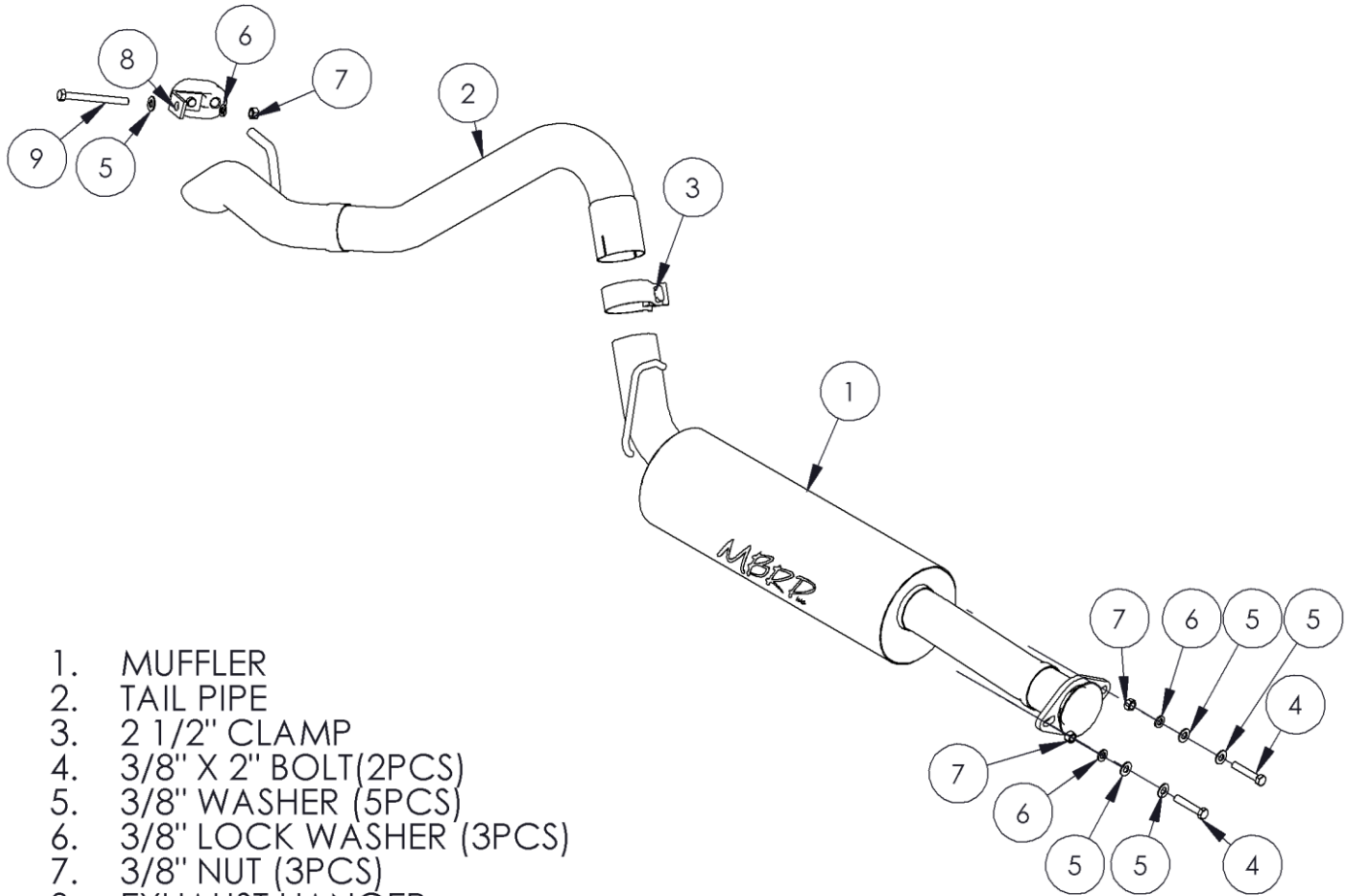

PERFORMANCE EXHAUST



- 1. MUFFLER
- 2. TAIL PIPE
- 3. 2 1/2" CLAMP
- 4. 3/8" X 2" BOLT (2PCS)
- 5. 3/8" WASHER (5PCS)
- 6. 3/8" LOCK WASHER (3PCS)
- 7. 3/8" NUT (3PCS)
- 8. EXHAUST HANGER
- 9. 3/8" X 4" BOLT

PLEASE READ BEFORE STARTING INSTALLATION

While MBRP Inc. has made every effort to ensure that all components of this system are of superior quality and properly packaged, it is the installer's responsibility to ensure the following before removal of the factory exhaust:

- that ALL components shown above are present.
- that ALL mating components fit together.
- that there are no damaged components.
- that the system you have purchased is appropriate for your vehicle year, model and configuration.
- that the system will not interfere with any modifications previously installed or planned.
- that you have read and understand these instructions.

If you have any questions or are uncertain about any aspect of the installation of this system to your vehicle please contact your dealer before commencing installation.

2004-2006 Jeep Wrangler/Rubicon (TJ)

Removal of Stock System:



Figure 1

1. Apply a penetrating lubricant liberally to all exhaust fasteners, hangers and rubber insulators.



Figure 2

2. Cut the exhaust pipe after the muffler to be able to remove it from the vehicle. **Refer to Figure 1.**

3. Remove the tail section of the exhaust by removing it from the rubber isolators. **Refer to Figure 2.**



Figure 3

4. Remove the hardware from the flange and remove the muffler. **Refer to Figure 3.**

Installation of MBRP Inc. Performance Exhaust:



Figure 4

1. Install the **Muffler** to the existing flange using the fasteners provided. Slide the **Muffler** hanger into the existing rubber isolator. **Refer to Figure 4.**



Figure 5

2. Slide the **2 ½" Clamp** over the **Muffler** outlet then install the **Tail Pipe** to the **Muffler**. Use the fasteners provided to install the **Exhaust Hanger** through the existing hole in the frame located just above the **Tail Pipe** hanger. Install the **Tail Pipe** hanger into the rubber isolator. **Refer to Figures 5 & 6.**

3. The existing Tail pipe hanger can be removed from the outside frame rail. **Refer to Figure 7.** Align the exhaust as required. Starting at the front of the exhaust, tighten all clamps and connections.



Figure 6

4. Check along the whole length of the exhaust system to ensure that there is adequate clearance around the spare tire, fuel and brake lines or any wiring. If any interference is detected relocate or adjust.

Congratulations! You are ready to begin experiencing the improved power, sound and driving experience of your MBRP Inc. performance exhaust system. We know you will enjoy your purchase.



Figure 7