

TAKTON

Replacement Soft Tops 4 Door JK



Parts List:

- 1x Fabric Top
- 1x Quarter Window, Right
- 1x Quarter Window, Left
- 1x Rear Window

Early JK Conversion Kit

- 1x Header Foam Pack
- 2x Fabric Spring Guards

Required Tools:

- Safety Glasses
- Masking Tape
- Phillips Screw Driver
- T-15 Torx Driver Or Bit Pliers
- T-30 Torx Driver or Bit (07-09 Models Only)

Before you begin Installation:

We are excited that you have chosen the Takton Fabric Replacement Soft Top. These quality tops are designed to enhance your driving pleasure while providing shade shelter from rain and wind. Though we have used only the finest materials in creating this top, any product that is exposed to the elements requires some general maintenance to keep it looking like new. Please see page 11 for these important maintenance tips. Please also note that it is normal for fabric to contract and wrinkle when stored in the shipping carton. In a few days the fabric will relax and wrinkles will disappear.

NOTICE

For a smooth fit and ease of installation, this top should be installed at temperatures above 72 degrees. Below this temperature, the fabric may contract an inch or more making it difficult to install. We highly recommend taking the top out of the package and letting it sit inside a warm place or direct sunlight for 1-2 hours before you install the top. When warm, this top will install quickly.

Installation of Fabric Replacement Top

HARDWARE



Factory Hardware Requirement:

This product is designed to fit over your original factory soft top hardware. Please see **HARDWARE** at left to make sure you have the correct hardware for this top.

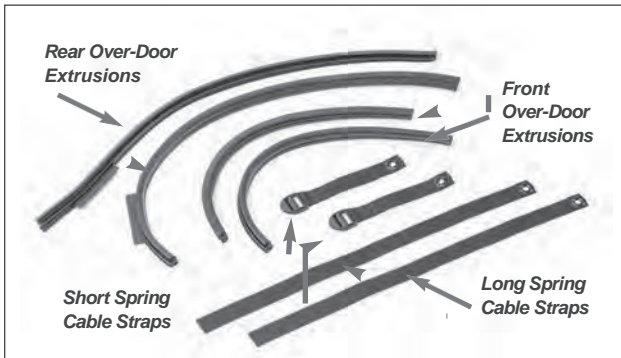

Early Model JK Conversion Kit:

If you have a 07-09 JK Wrangler you will be using the enclosed conversion kit to install your top. This kit turns your regular top into a "cable style top" making it easier to fold the top back. This conversion kit is only included in 07-09 Applications.

Note: Picture shows grommets on each end of the spring straps. The one end of the strap may have a "D" Ring installed instead of a grommet.

Installation of Fabric Replacement Top



Step 1: Remove Existing Soft Top Fabric
Put on safety glasses. After verifying that you have the correct factory original bow system and hardware, remove the existing soft top from the vehicle.

This process will entail removing all Quarter windows, unscrewing the top from the rear bows and removing the fabric from the windshield header by unscrewing 19 or 27 header screws (Depending on model year). See Step 1a on next page for proper removal of header fabric.

Make sure you keep all screws and fasteners in a safe place after removal. You will be using them again later in the installation. See FIGS 1, 2, 3 & 4

Once the soft top is removed, inspect all of your hardware to make sure no parts are bent or missing.



Step 1A: Detach Old Top Fabric from Header

For Model Years 2010-2018 Only:

You will need to peel back the corner foam and unscrew the cable attachment on both ends of the header using a T-15 Torx.

For Model Years 2007-2009 Only:

You will need to peel back the foam and remove the two corner screws that hold a plastic mounting flange located in the same vicinity.



See FIGS 5, 6, 7 & 8.

NOTICE

The following header installation will be easier to accomplish with the help of another person. This step will most likely be the most difficult step in the install and you should take your time. The easiest way to install this header is standing on the front seats facing forward.

We suggest placing a towel or cover on the seats to protect them from dirt & debris from your shoes. Once the soft top header fabric is installed in the factory header, the remaining installation is very straight forward.



Step 2: Install New Fabric to The Header

With old top completely removed and the top header plate unscrewed from the lower header, raise the bow assembly and lock header to the windshield (See FIG 9). As seen in FIG 10, drape the soft top fabric backing side up over the hood and the windshield and locate the front extrusion sewn into the front header of the Top. Locate masking tape and have it ready for step 3.

Installation of Fabric Replacement Top

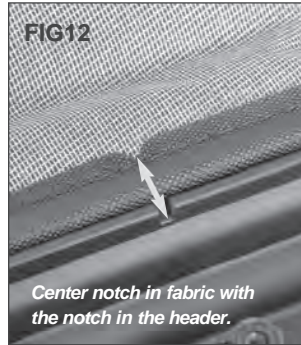

Step 3: Center New Fabric on Windshield Header and Secure With Tape

Slide the sewn in extrusion along the front edge of the top into the channel of the lower header that is secured to the windshield in step one. See FIG 11.

Locate and line up the center notch in the middle of the fabric to the center of the channel centering the fabric on the lower header. Secure the fabric around the center notch with masking tape. See FIG 12.

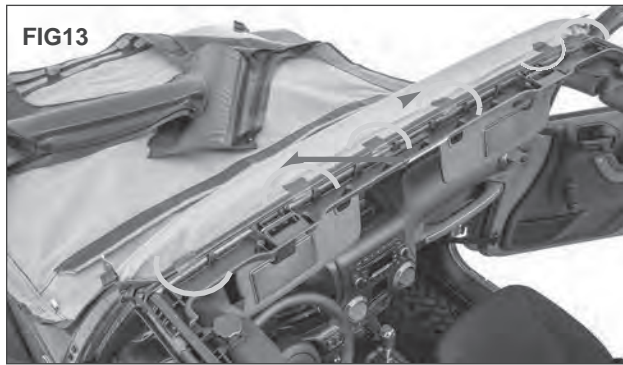

Step 4: Securing the Top in Lower Header

Working from the center out, secure the top in the lower header channel with masking tape holding it in place for installing the top plate to the lower header.

Use 5-6 pieces of tape to hold the top in place.

Note: The tape pieces will be completely covered when the top plate is put back on the lower header.

See FIGs 13, 14 & 15.



Step 5: Complete Header Re-Assembly

Close the upper header over the taped down fabric sandwiching the fabric but leaving the underside faced up on the hood (See FIG 16).

Using the screws you removed in step one, reinstall the four corner screws and then the 19 or 27 (depending on model year) screws along the top of the header. See FIG 17 & 18.



Un-latch the bow assembly from the windshield (inside vehicle) and lower the bow assembly to the rear of the vehicle folding the top back over with the underside of the fabric facing down (see FIG 19)

Installation of Fabric Replacement Top

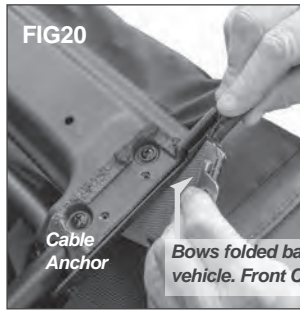

Bows folded back to rear of vehicle. Front Corner shown.

Step 6: Complete Header Re-Assembly

Slip the corner pocket sewn into the top between the header and position the cable anchors over the two holes with the cable facing the outside of the header (FIG 20 & 21).

Note: on 07-09 models the screw holes may not line up exactly and some hole relocation may be required using a drill. Reinstall the cable anchor screws on each side of the header as shown in FIG 21.



Step 7: Small Foam Strips to Header

Locate the Header foam packet and attach foam over the installed cable anchors on each side of the header.

Install the small "strip" foam on the front of the header as shown in FIG 22.



Step 8: Drape Top and Secure Bow Assembly

Drape the top fabric over the cab reinstalling and securing the bow assembly above the door. The front header should be resting on the windshield but not attached or clamped and the top fabric should be laid back but not attached to the rear bows. See FIG 23 (2 door shown).

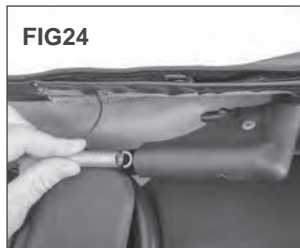

Step 9: for 2010-2018 JKU 4-Door Wrangler

Securing the Cable Spring on 2010-2018 Models.
If you have a 07-09 JK 4 door skip to step 9A (page 6).

Locate the Cable spring hanging out of the top behind the rear seat next to the rear vertical door surrounds. Fold back the front header to reduce the side cable tension. On 2010-2012 models the rear bracket where the cable spring is to be attached is exposed or under a fabric sleeve. With the front header tension released, attach the spring to the bracket and using a set of pliers, crimp the spring end closed so it cannot be easily slipped off (see call out on FIGs 26 & 27).



For 2013-2018 models the bracket is encased in a plastic "tube". As shown in FIGs 24-27, slip the cable spring through the "tube" and attach it to the top bracket and using a set of pliers, crimp the spring end closed so it cannot be easily slipped off.

NOTICE

We have enclosed new fabric covers to cover the attached spring mechanism. These can be used on 2010-2012 vehicles to cover the spring or on '13-'18 vehicles if the plastic "tube" is damaged during original soft top removal.

Installation of Fabric Replacement Top

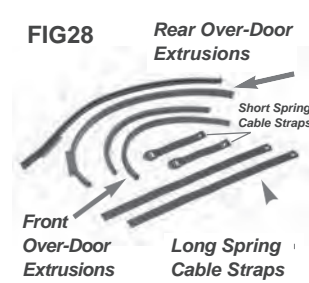

Step 9A: for 2007-2009 JKU 4-Door Wrangler

Securing the Cable Spring using the Early Model Conversion Kit. Locate the early model conversion kit. With the front header resting on the windshield and the remainder of the top draped over the rear bows, fold back the front header to reduce tension in the cable. Locate the Cable spring hanging out of the top behind the rear seat next to the rear vertical door surrounds. Locate the Cable spring straps (FIG 28) and loosely thread the long strap through the buckle as shown in FIG 29 so that there is a grommet on one end and a "D" ring on the other end of the combined strap.

Attach the short strap end "D" ring to the cable spring and using a set of pliers, crimp the spring end closed so it cannot be easily slipped off. Wrap the strap around the outside of the Sport bar and down attaching it (remove top bracket bolt with a T-30 Torx, slip bolt through Grommet and re-attach) to the top bolt hole where the soft top hardware is installed. See FIGs 30 &31. Repeat the above for opposite side of top.

CAUTION

Do not tighten the side cable spring strap at this time. The front header must be closed and locked before you tighten the cable spring straps!

WARNING

When installing the strap make sure you do not hinder the use of the seat belt. The strap should go inside the vehicle under any seat belt strap.



Step 9B: for 2007-2009 JKU 4-Door Wrangler

Securing Rear Over-Door Extrusions from Conversion Kit. The cable sewn into the top needs to rest inside of a "rain gutter" to seal properly. This step installs the rain gutter "extrusion" to your hardware. Locate the Rear over door Extrusions (See FIG 28).

Line up the rear extrusion with the gap in the hardware and slowly but firmly push the extrusion up into the lip of your door surrounds.



The soft lip should be facing up and the small plastic strip should fill in the gap on the door surround hardware. Work your way back towards the rear of the vehicle securing the extrusion along the way. Repeat the above for opposite side of top.

See FIGs 32-34.

Installation of Fabric Replacement Top

FIG28



FIG35

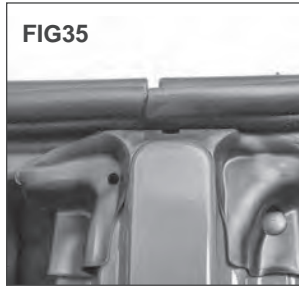

Step 9C: for 2007-2009 JKU 4-Door Wrangler
Secure Front Over Door Extrusion Conversion Kit.

Locate the Front over door Extrusion (See FIG 28). Line up the front extrusion with the end of the rear extrusion (attached in step 9B) and slowly but firmly push the extrusion up into the lip of your door surrounds. The soft lip should be facing up.

FIG36



FIG37



Work your way forwards towards the Front of the vehicle securing the extrusion along the way.

Repeat the above for opposite side of top.

See FIGs 35-37.

FIG38



FIG39



Step 10: Reinstall Center Bow Screws

Fold the top fabric forward to Expose Bow #2. Reinstall the 4 screws that attach the center bow (Bow #2 over front of rear quarter window opening). These screws are the ones previously removed from your original top. On some models the straps may have to wrap around the opposite side of the bow. Regardless, the bow straps should be tight. See FIGs 38 & 39.

FIG40



FIG41



Step 11: Reinstall Rear Bow Screws

Reinstall the 4 screws that attach the rear bow (Bow #3 over rear window opening).

These screws were previously removed from your original top. On some models the straps may have to wrap around the opposite side of the bow. Regardless, the bow straps should be tight. See FIGs 40 & 41.

Reinstall 4 Screws

FIG42



From inside the vehicle, attach the hook and loop flap around the front bow (Bow #1 over the sound Bar). See FIG 42.

Installation of Fabric Replacement Top



Step 12: Attach Rear Corners into Body

With all the bows attached to the top, pull down on the rear bow while securing the rear corners into the retainers on the vehicle.

Note: On 07-09 models the side spring cable straps should still be loose. You will tighten these straps after step 13 below.

See FIGs 43 & 44



Step 13: Secure Front of Top to Windshield

With the cable spring installed, and the rear corners hooked into the body retaining channel, use two people and simultaneously fold the header forward. Use the front header latches to secure the front of the top to the windshield. See FIGs 45-47.

Please Note: With the rear corners attached the first time you fold down the front header it will be EXTREMELY TIGHT. This is normal. We highly recommend that two people fold down the header simultaneously. This will prevent possible damage to the hardware system.

For 07-09 applications only:

With the front Headers latched, tighten the side spring cable straps. See FIG 48.



CAUTION

The leading edge of the soft top must be secured to prevent the loss of the top at speed. Latches must be fully closed and free of mud and other contamination. Do not use top if either latch is damaged.

NOTICE

If there are small "puckers" that form on the rear seam after the front header is secured, we suggest unscrewing and reinstalling the rear bow screws after step 19 with the rear window installed.



Step 14: Attach Quarter Window Zippers

Attach the quarter window zippers by starting the zipper on the quarter window and zipping it closed 2-3 inches.

Repeat this on the other side of the vehicle. See FIGs 49 & 50.

Installation of Fabric Replacement Top



Step 15: Attach Front of Quarter Windows
Attach the front of the quarter windows along the front edge of the vertical door surround by rolling the plastic into the slot on the door surround.

Repeat the above for opposite side of top.

See FIGs 51, 52 & 53



Step 16: Attach Bottom of Quarter Windows
Roll the bottom of the quarter window into the retainer channel on the vehicle and then close the quarter window zipper the rest of the way.

Close up the hook and loop fasteners around the zippers.

Repeat the above for opposite side of top.

See FIGs 54, 55, 56.

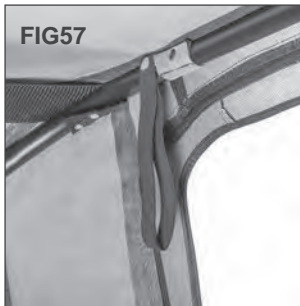

Step 17: Attach Elastic Window Straps
Snap the elastic window roll straps on the rear bow above the rear window opening.

These straps can be used to secure your rear window when rolled up.

See FIGs 57 & 58

NOTICE

Before Rolling up the rear window, make sure the glass is clean.
Dirt and Debris can cause scratches when rolled up.

Installation of Fabric Replacement Top



Step 18: Prepare Rear Window for Installation

Locate the rear window and place it on a soft, clean surface with the backing side up.

Take the factory bar removed in step one and orient the "C" Channel with the round seal facing down and slide the "C" Channel onto the rear window retainer as shown in FIGs 59 & 60.



After sliding the retainer all the way through the "C" Channel, roll the tailgate bar into the mounts with the outside of the fabric facing towards the rear of the vehicle.

See FIGs 61 & 62.



Step 19: Secure Rear Window & Final Fit

Secure the rear window zippers by pulling the two zipper sliders all the way down as far as possible in order to catch the sliders on the zipper pin. Once the zipper is caught, raise the zipper 1"-2".

Hold the top of the window with one hand and zip up the zipper all the way with the other hand. Make sure that the tailgate bar is centered. If the zippers have too much distance between the window and the top, slide the rear corners around towards the middle of the vehicle until the zippers can be closed.

See FIGs 63 & 64.



Tuck the flaps under the window zippers into the retainers to secure the rear window.

See FIGs 65 & 66.

Top Installation is now complete!

⚠ WARNING ⚠

When operating the vehicle with the quarter windows removed, the rear window should be rolled up and secured with the elastic straps or completely removed for proper ventilation.

Care and Maintenance of your Takton® Product:

Your Takton Replacement Top is made of the finest materials available but to keep it looking new and for the maximum possible wear, it will need periodic cleaning and basic maintenance. The main threat to your soft top is pollutants, dirt and grime. By keeping your top clean you will prolong the life of your top.

We recommend the following to keep your top like new:

Washing:

The soft top fabric should be washed often using a mild soap, warm water and a soft bristle brush. You can also use special soft top cleaners available on our Distributors websites. Make sure that after cleaning you rinse with clear water to remove all traces of soap to avoid residue.

Water/Fabric:

In the event of seeping through the seams, 3M Scotchgard® may be applied on the inside of the seams to stop the seeping. Rips in the fabric may be repaired with Bondex® iron on patches. Iron the patches to the Inside of the top, carefully following the Bondex® instructions.

Windows:

It is very important that you keep your Soft Top windows clean! Use a mild soap and water solution to gently clean your windows. NEVER wipe your windows clean with a dry cloth! Dust and dirt on a dry cloth can scratch your windows causing "fogging" and permanent damage. When removing your windows, store them with a towel. If frost or ice forms on the outside of your windows during the winter, DO NOT use an ice scraper to remove this frost. Over time you will see small micro scratches in your windows which are natural wear and tear. These Micro scratches can be "polished" out using the window polish available at your Takton Distributor.

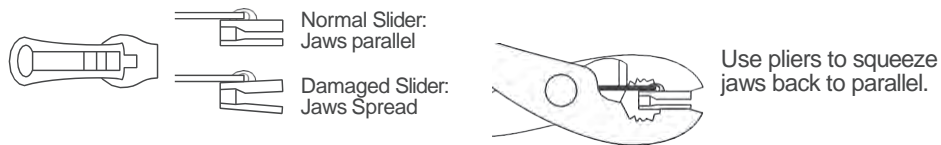

Zippers:

Keeping the zipper cleaned and lubricated with a silicone lubricant (available online) will help prevent damage and keep the zippers in a smooth working condition. If zipper opens behind the slider, the slider may have been spread apart. This problem can usually be fixed by using an ordinary pair of pliers to bring the sides back into parallel. Return slider to the end of the zipper in the normal Open position. Squeeze lightly at first and test zipper. If the zipper continues to remain open squeeze more firmly with pliers and try the zipper again. Repeat procedure until your zipper operates correctly.

