

## INSTALLATION INSTRUCTIONS

MAKE: Jeep  
MODEL: Wrangler JK (4 Door)  
YEAR: 2007-2016  
ENGINE: V6-3.8 / 3.6L

Cat-Back w/ Polished Tip  
Aluminized Steel  
49-08044-1P

**aFe recommends professional installation on our products.**

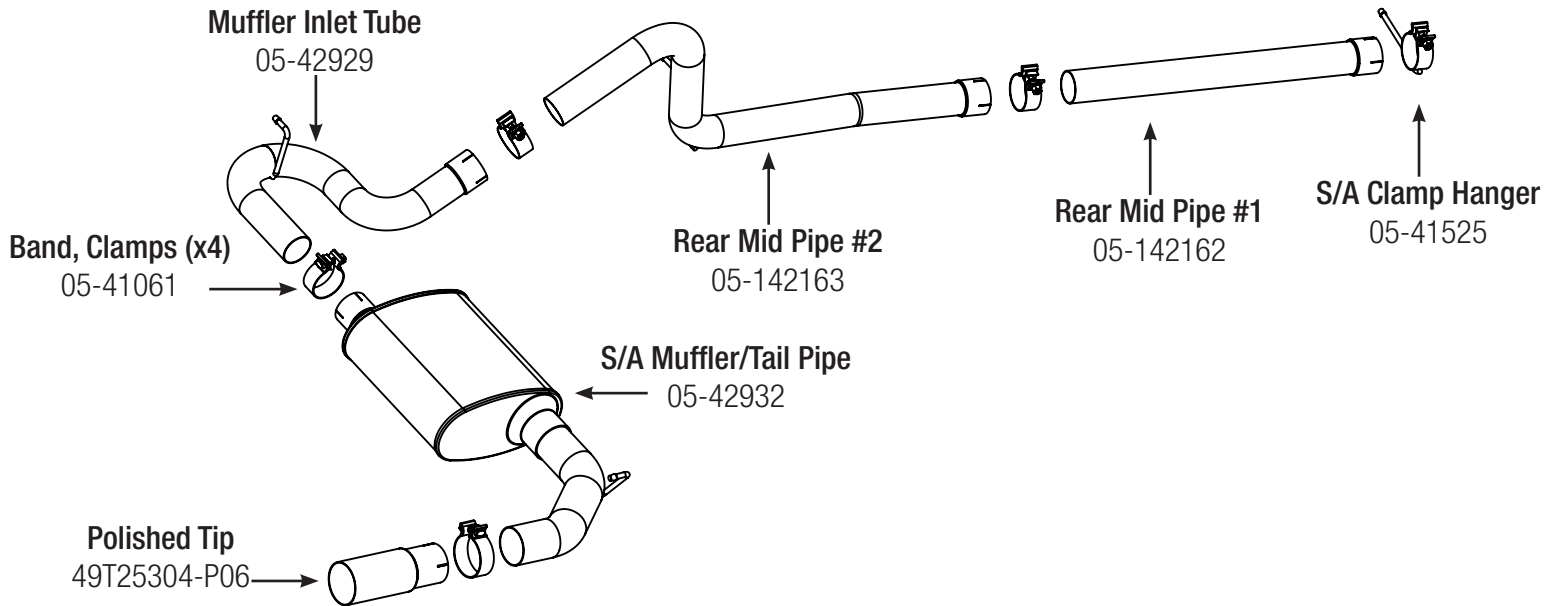

**Caution:** Allow time for your vehicle to cool down prior to installation. When working on or under your vehicle proceed with caution. Exhaust systems reach high temperatures and may cause serious burns. Wear protective safety equipment; eye goggles and gloves to ensure a safe installation.

- Step 1:** Secure vehicle on jack stands (Refer to your manual for specified jack stand positions).
- Step 2:** Loosen the band clamp securing the OE muffler to the mid pipe.
- Step 3:** Remove the muffler off the rubber hanger mounts and then slide off the mid pipe.
- Step 4:** Loosen the band clamp securing the OE mid pipe to the y-pipe.
- Step 5:** Remove the OE mid pipe off the rubber hangers and then slide off the y-pipe.
- Step 6:** Slide the supplied assembly hanger rod over the aFe Mid Pipe (The hanger rod should face the bottom and point left),(x1) supplied 2.5" band clamp and install onto the y-pipe and rubber hanger mount. Do not tighten the band clamp or hanger rod assembly.
- Step 7:** Using (x1) supplied 2.5" band clamp, install the aFe Muffler Inlet Pipe onto the Mid Pipe and rubber hanger mount but do not tighten.
- Step 8:** Using (x1) supplied 2.5" band clamp, install the aFe Muffler Section onto the muffler inlet pipe and rubber hanger mount but do not tighten.
- Step 9:** Using (x1) supplied 2.5" band clamp, install aFe clamp on tip but do not tighten.
- Step 10:** Align aFe exhaust system and then tighten all band clamps and hanger rod assembly.
- Step 11:** Re-check all your work.
- Step 12:** Remove vehicle off jack stands.
- Step 13:** Your installation is now complete. It is recommended to re-tighten all exhaust components after 50-100 miles.

**NOTE:** It is normal for the aFe Exhaust System to emit smoke for the first few minutes upon initial start-up.