



INSTALLATION GUIDE

Installation Guide for the 2WD Low range kit Part #002204000 (2LOW231)



Installing this kit is identical to replacing the stock range shift fork and sector. We recommend you have a service manual for reference when removing and replacing the transfer case assembly. The service manual should also be used for disassembly and assembly of the transfer case assembly.

These instructions begin with the transfer case on the bench and the front and rear housings separated. Also remove the mainshaft and drive chain.

Tera Manufacturing, Inc.
5251 South Commerce Dr.
Murray, Utah 84107
Phone/801.288.2585
Fax/801.713.2313
www.teraflex.biz

Prior to beginning any work on your transfer case, please verify that your kit contains the following items:

- Contents:
- 1 Range fork
 - 1 Sector assembly
 - 1 Pad kit set (3 pieces)
 - 1 Sticker
 - 1 Instructions

1. Remove the indicator switch from the front case (if so equipped).

2. Remove shift detent screw, spring, and poppet. (Fig. 1).

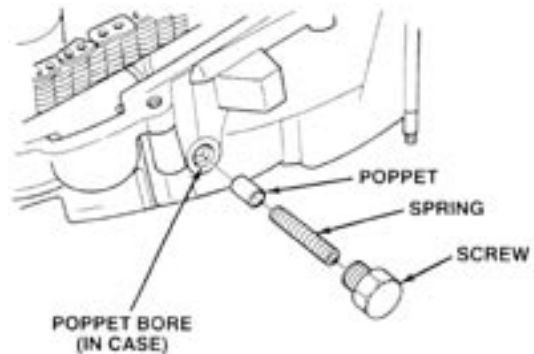

3. Remove range lever, nut and washer. (Fig.2).

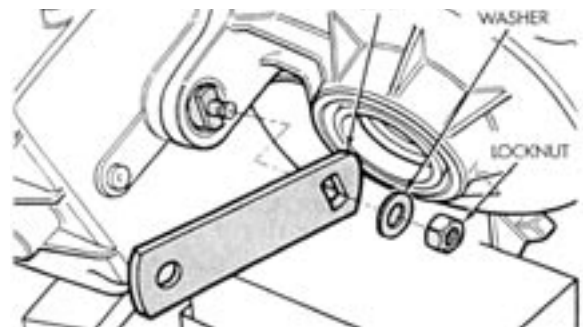

4. Remove mode fork and shift rail. (Fig. 3).

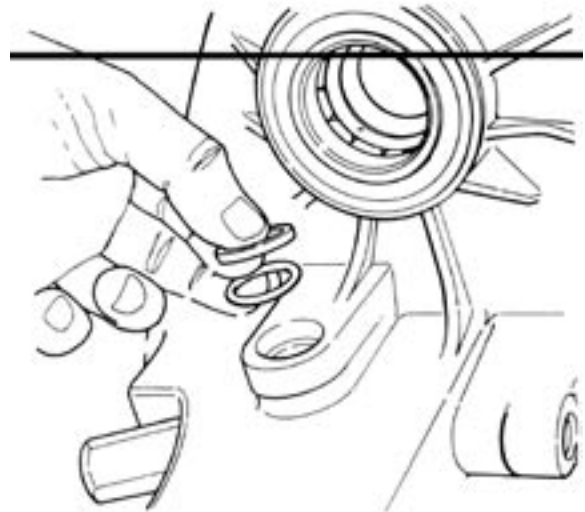
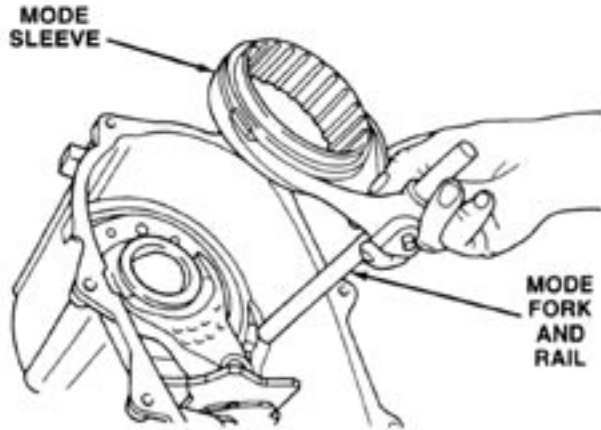

5. Remove range fork. (Fig. 4).

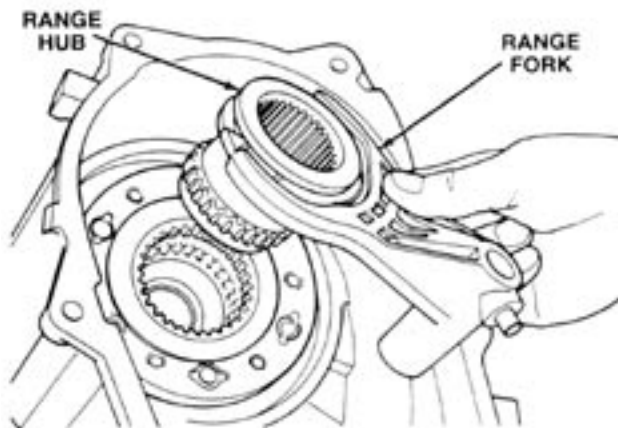

Make sure you do not lose the O-ring and bushing. (Fig. 6).

9. This diagram indicates the new shift pattern with the 2Low231 installed.

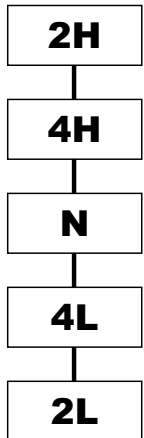

6. Remove sector. (Fig. 5).

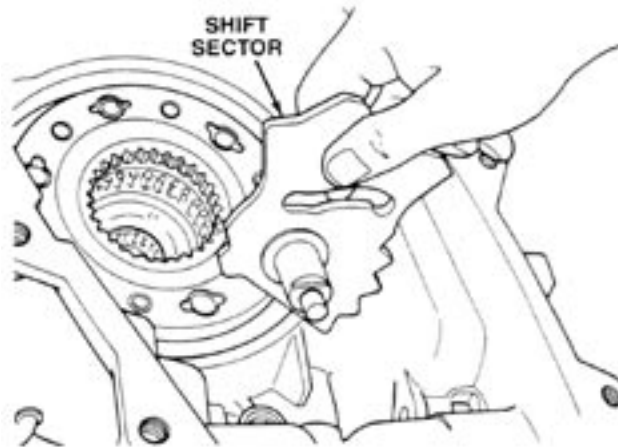

Shift Linkage Adjustment

Shift Transfer Case into 2H. Raise vehicle. Loosen lock bolt on adjusting trunnion. Be sure linkage rod slides freely in trunnion. Clean rod and apply spray lube if necessary. Verify that transfer case range lever is fully engaged in 2H position. Tighten adjusting trunnion lock bolt. Lower vehicle. Test drive vehicle to confirm all shift positions

7. Make sure the new wear pads are firmly pushed on to the new shift fork.

8. Install the new parts in reverse order of steps 1-6.

(Fig. 7). Typical shift linkage. Some components vary by vehicle year and model.

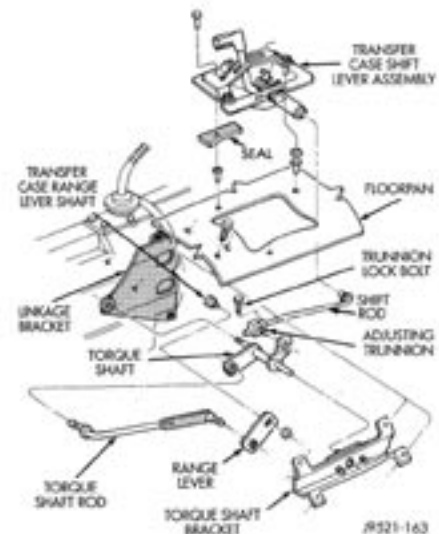

Exploded View of the 231J Transfer Case

○ Included in the Tera 2Low231 Heavy Duty 2WD Low Range Kit

Note: This diagram shows the Tera Low231 Heavy Duty Short Shaft kit, Tera Low231 4.0:1 case, and the Tera Low2WD kit. A stock setup will appear different than pictured.

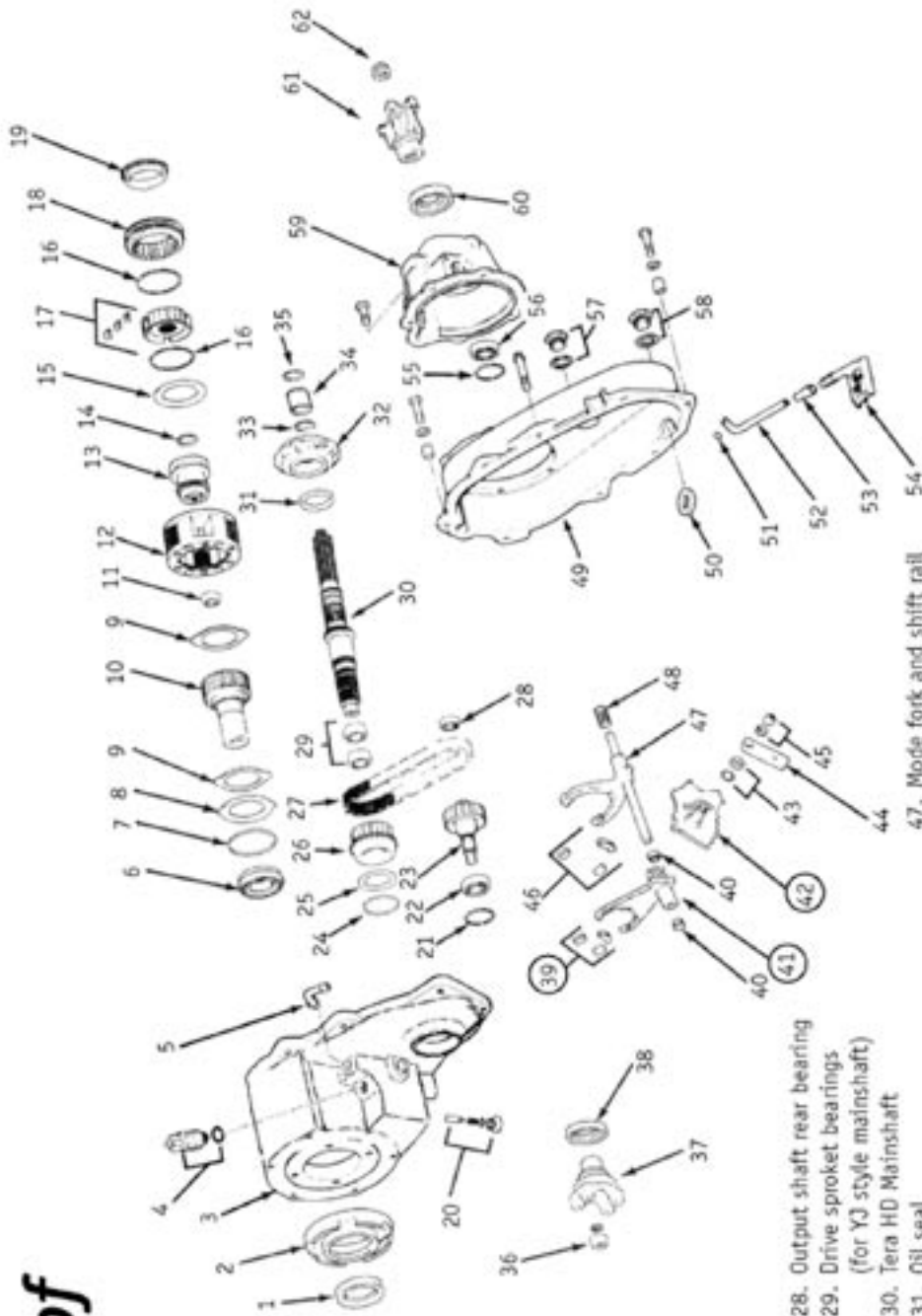

1. Front input seal
2. Front bearing retainer and seal
3. Tera HD Low231 case
4. Vacuum switch and seal
5. Vent assembly
6. Input gear bearing and snap ring
7. Low-range gear snap ring
8. Input gear retainer
9. Low-range gear thrust washer
10. Input gear
11. Input gear pilot bearing
12. Planetary gear assembly
13. Range fork shift hub
14. Synchro hub snap ring
15. Shim
16. Synchro hub springs
17. Synchro hub and inserts
18. Synchro sleeve
19. Stop ring
20. Shift detent plug, spring, and pin
21. Snap ring
22. Front output shaft bearing
23. Front output shaft
24. Large snap ring
25. Shim
26. Drive sprocket
27. Drive chain
28. Output shaft rear bearing
29. Drive sprocket bearings (for Y3 style mainshaft)
30. Tera HD Mainshaft
31. Oil seal
32. Oil pump assembly
33. Snap ring
34. Speedometer drive gear
35. Snap ring
36. Front yoke nut
37. Front yoke
38. Front output seal
39. Range fork inserts
40. Range fork bushings
41. Range fork
42. Sector
43. O-ring and seal
44. Range lever
45. Range lever nut and washer
46. Mode fork inserts
47. Mode fork and shift rail
48. Mode spring
49. Rear case
50. Magnet
51. Pickup tube oil ring
52. Mode fork inserts
53. Tube connector
54. Oil pickup screen
55. Snap ring
56. Rear bearing
57. Fill plug and gasket
58. Drain plug and gasket
59. Rear housing
60. Rear output seal
61. Rear yoke
62. Rear yoke nut



Tera Manufacturing, Inc.
5247 South Commerce Dr.
Murray, Utah 84107
Phone/801.288.2585
Fax/801.713.2313
www.teraflex.biz