

## Raxiom Rear Cargo Light

### Installation Guide for Jeep Wrangler '07-'16 2-Door JK

**Installation Time:** <1 Hour

**Tools Required:**

- ✓ Box Cutter/Knife
- ✓ 9V Battery

**Installation Instructions:**

1. Carefully open the package using a box cutter or knife (Figure A) and ensure the product is included and undamaged.



Figure A

2. Turn the Raxiom light over and locate the slot for the 9V battery (not included) (Figure B).

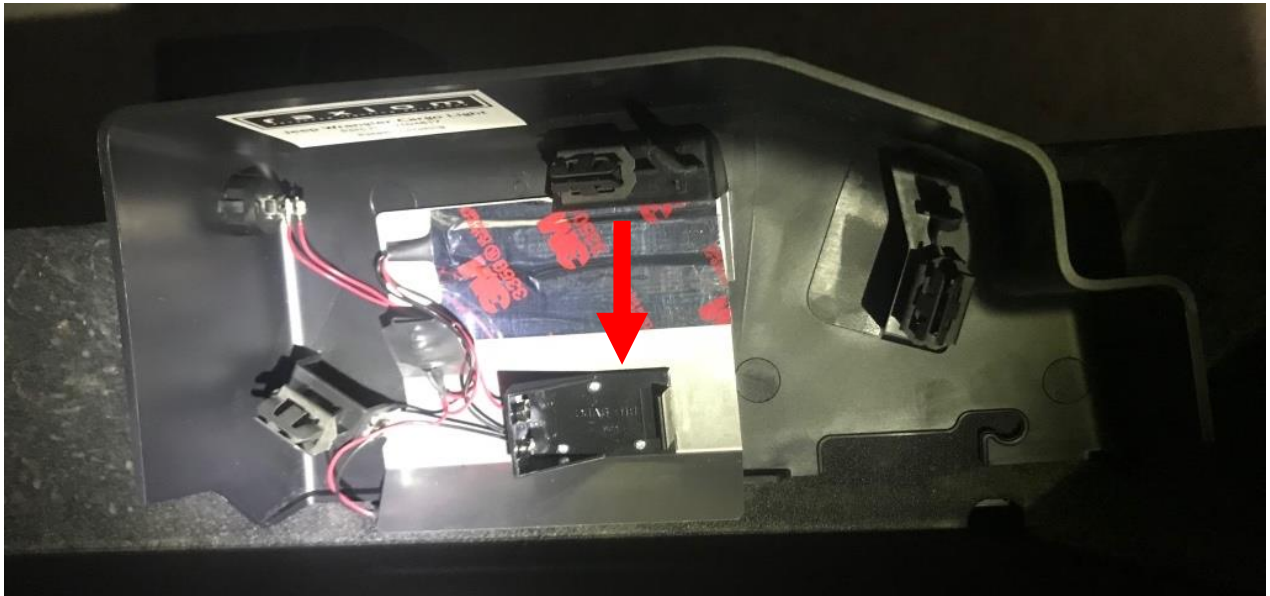

Figure B

3. Insert the 9V battery (Figure C).



Figure C

4. Remove the cover from the rear window by pulling down with pressure (the interior is held by metal clips which will release after an abrupt downward tug) (Figure D).



Figure D

5. Place the Raxiom light in place of the cover just removed, ensuring to align all three clips and press in firmly (Figure E).



Figure E

6. Ensure the light works properly by flipping the on/off switch on the side. The light should turn on immediately (Figure F).



Figure F



Before



After

Installation Instructions Written by ExtremeTerrain Customer J. Sandlin 12/20/2017